

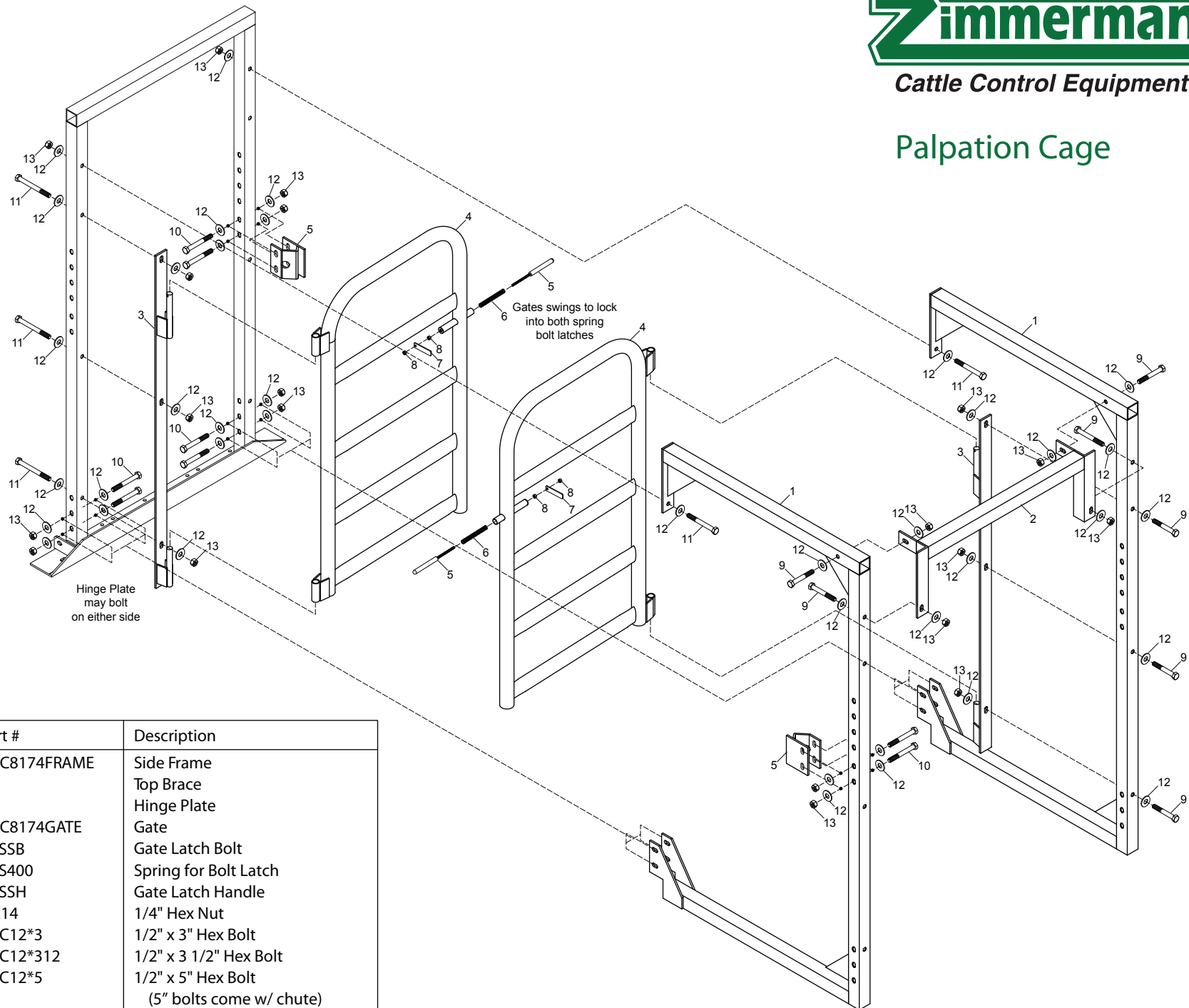

Cattle Control Equipment

Palpation Cage



Ref #	Qty.	Part #	Description
1	2	HPC8174FRAME	Side Frame
2	1		Top Brace
3	2		Hinge Plate
4	2	HPC8174GATE	Gate
5	2	GLSSB	Gate Latch Bolt
6	2	GLS400	Spring for Bolt Latch
7	2	GLSSH	Gate Latch Handle
8	4	NC14	1/4" Hex Nut
9	7	H5C12*3	1/2" x 3" Hex Bolt
10	8	H5C12*312	1/2" x 3 1/2" Hex Bolt
11	5	H5C12*5	1/2" x 5" Hex Bolt (5" bolts come w/ chute)
12	40	FW12	1/2" Flat Washer
13	20	NC12	1/2" Hex Nut