

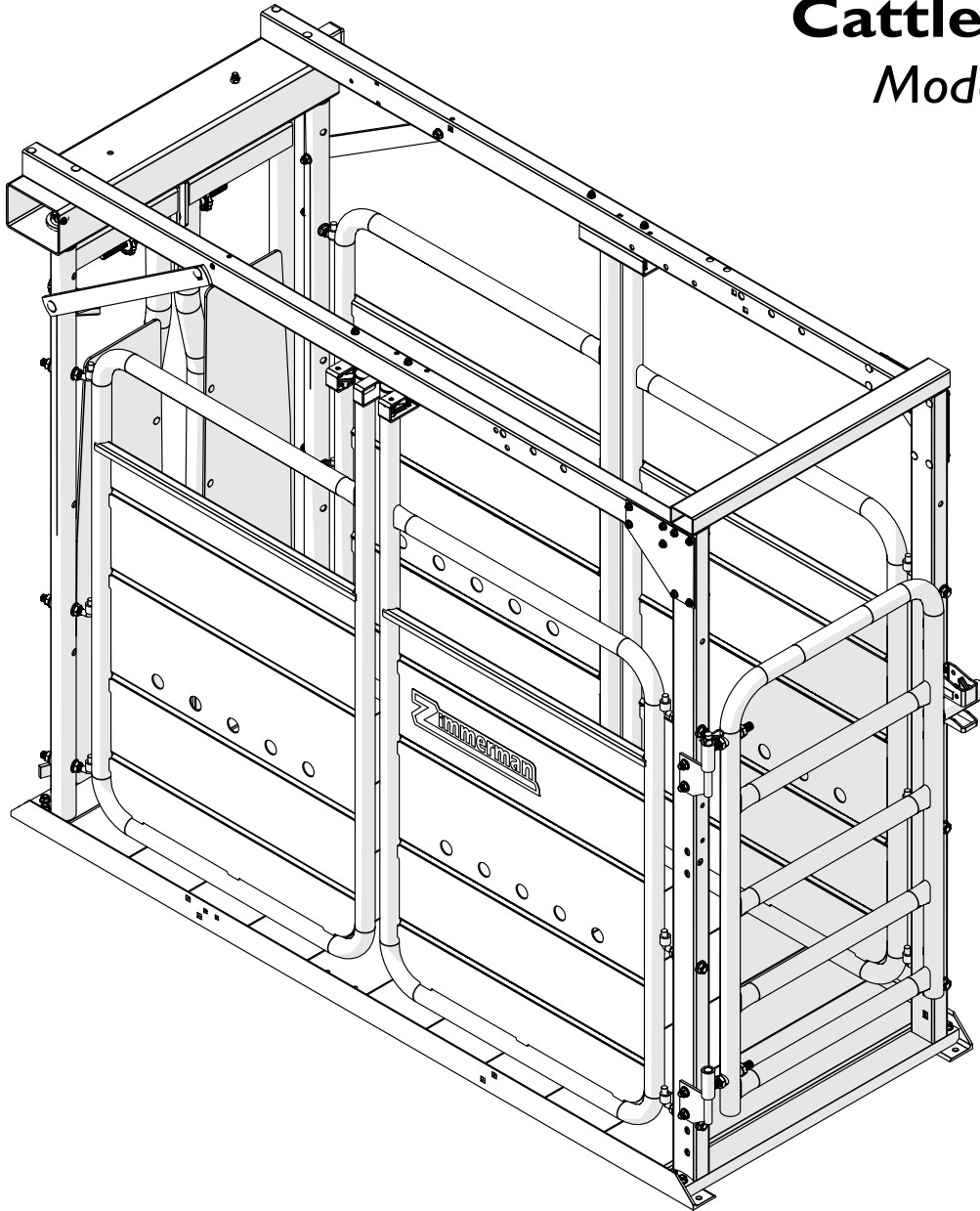

Assembly Instruction Manual

Cattle Chute
Model ECC12



PBZ LLC | 50 Wood Corner Rd | Lititz PA 17543
www.CropCareEquipment.com | (717) 738-7365
A Paul B Zimmerman Inc. Company

Form OM0018
Rev. Date 1/1/11

ECC12 Assembly Instructions

The Cattle Chute, model ECC12, comes partially assembled on a pallet and requires some assembly. Follow the step-by-step instructions to ensure proper assembly. Before assembling, ensure that the pallet contains all of the necessary components and parts .

Pallet (as shipped)

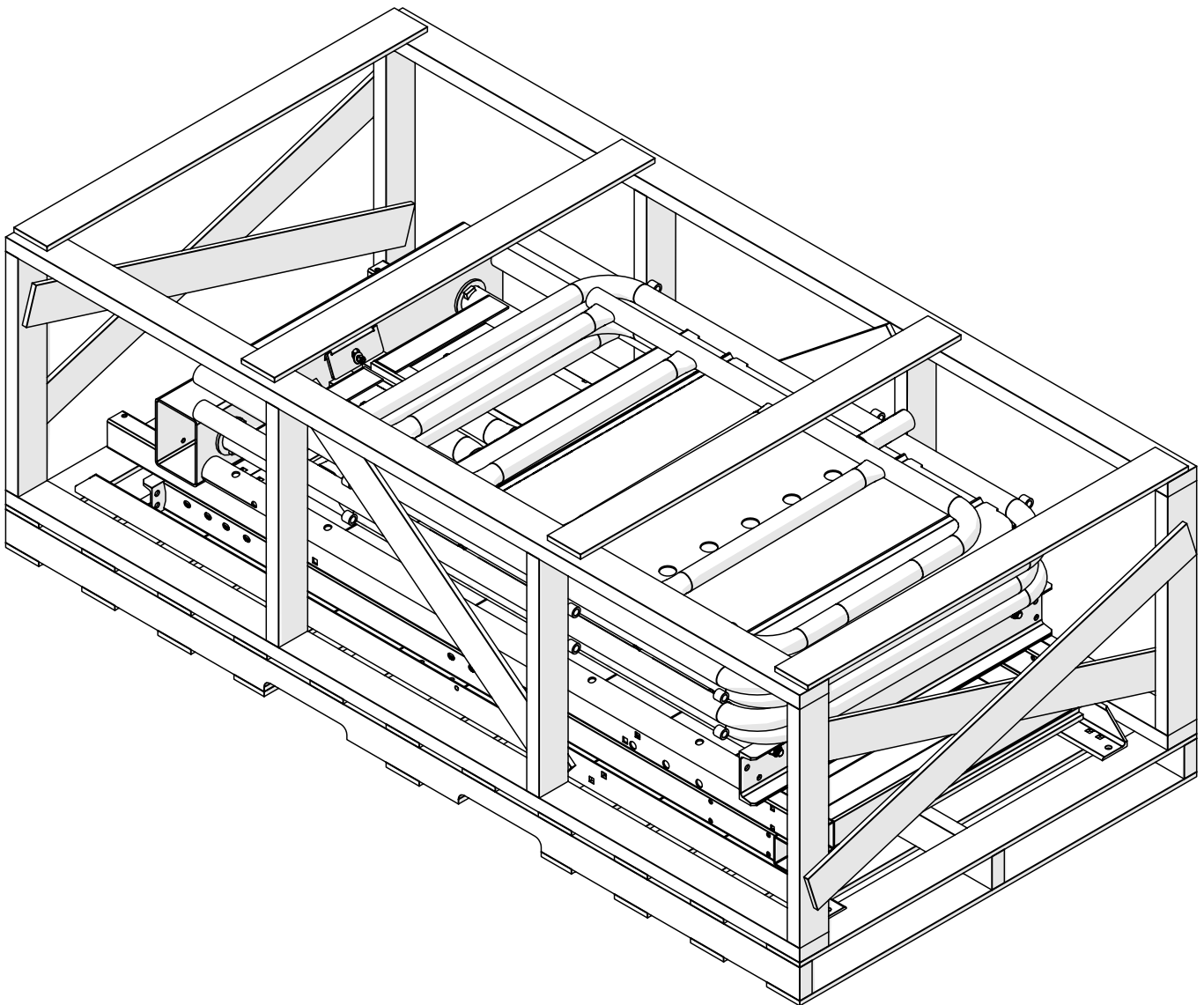

ECC12 Assembly Instructions

Pallet Contents

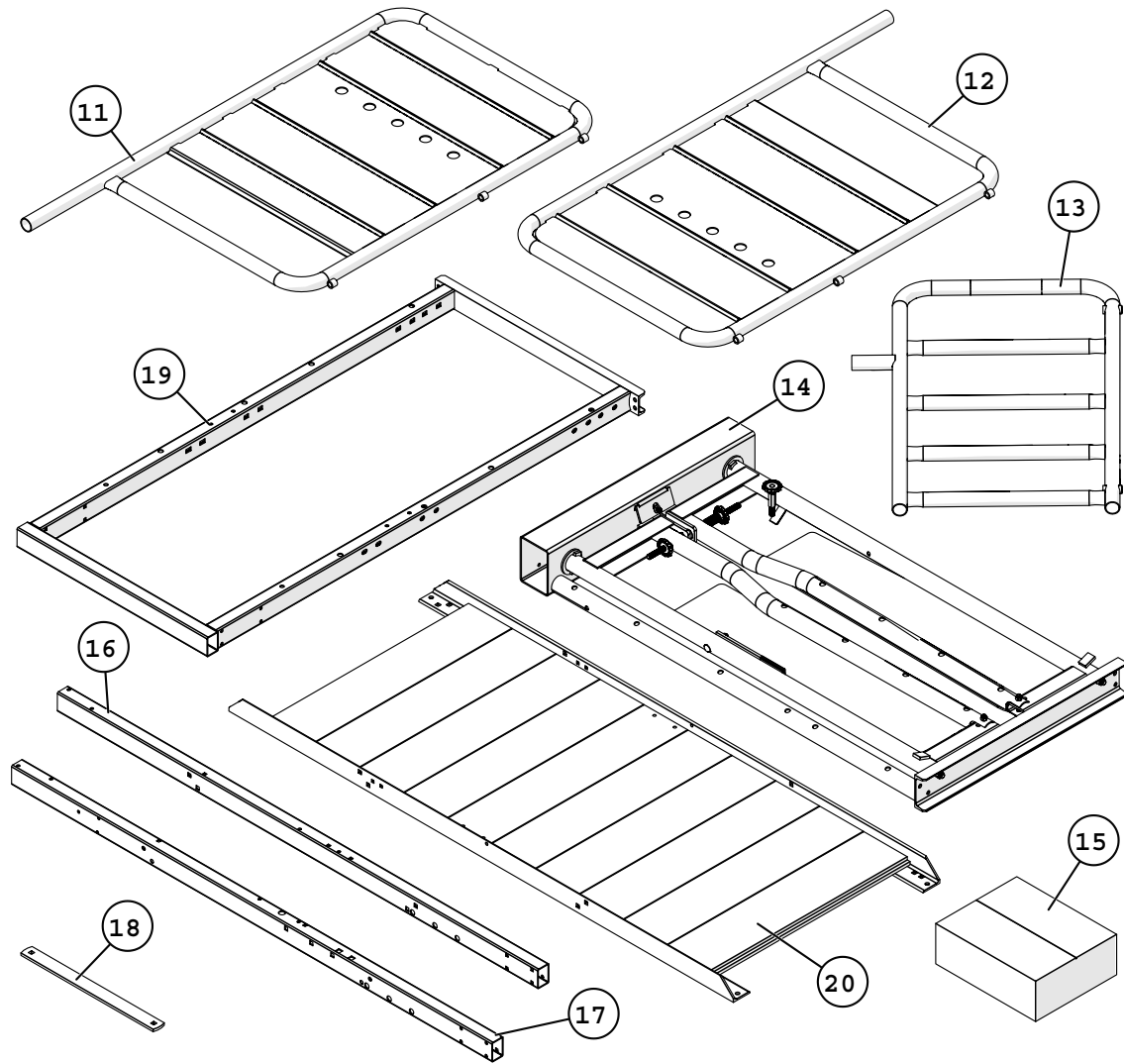

Ref #	Qty	Part Number	Description
11	2	HVC027	Large gate, right
12	2	HVC026	Large gate, left
13	1	G4803	48" gate, 3' long
14	1	AHG2011	Automatic headgate assembly
15	1	--	Hardware box
16	1	HVC002	Top tube rail
17	1	HVC001	Top tube rail
18	2	HVC028	Front frame strap
19	1	HVC003	Rear frame
20	1	--	Floor (pre-assembled)

ECC12 Assembly Instructions

Hardware Box Contents

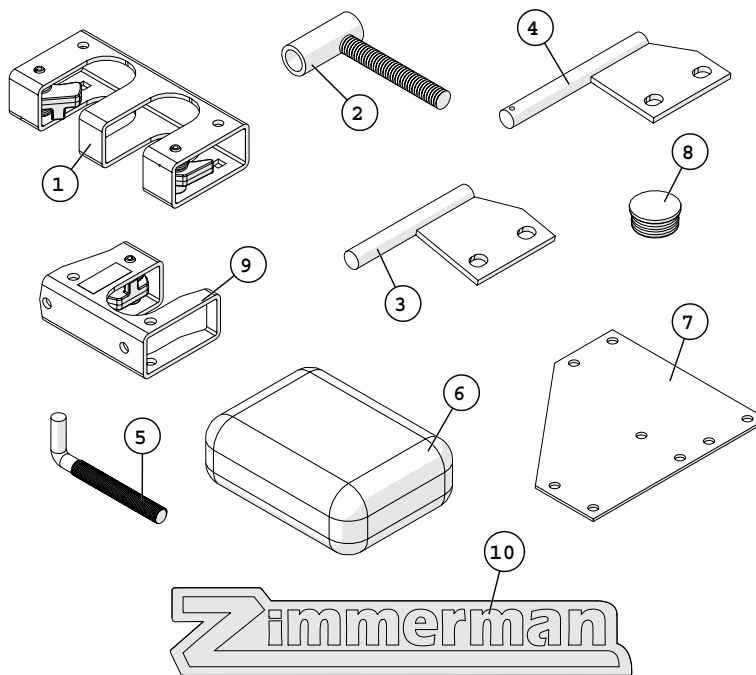

Ref #	Qty	Part Number	Description
1	2	GL201	Double gate latch
2	2	GHA	Gate hinge
3	1	HSG8148-6	Bolt on hinge pin-6"
4	1	HSG8148-7	Bolt on hinge pin-7"
5	12	HVC037	Hinge pin
6	1	**	Hardware bag
7	2	HVC007	Rear frame gusset
8	4	GTP	Gate tube plug
9	1	GL100	Single gate latch
10	2	PBZLOGO-17X4	Zimmerman logo - 17" x 4"

** Hardware bag contents listed below

Hardware Bag Contents

Qty.	Part Number	Description
2	CB12*3I2G5	Carriage bolt, 1/2-13 x 3 1/2" grade 5
6	CB12*3G5	Carriage bolt, 1/2-13 x 3" grade 5
4	CB12*2I2G5	Carriage bolt, 1/2-13 x 2 1/2" grade 5
4	CB12*2I4G5	Carriage bolt, 1/2-13 x 2 1/4" grade 5
4	CB38*5I2G5	Carriage bolt, 3/8-16 x 5 1/2" grade 5
4	CB38*3I2G5	Carriage bolt, 3/8-16 x 3 1/2" grade 5
16	CB38*2I2G5	Carriage bolt, 3/8-16 x 2 1/2" grade 5
24	FN58	Flange nut, 5/8-11
16	FN12	Flange nut, 1/2-13
26	FN38	Flange nut, 3/8-16
2	CB38*334	Carriage bolt, 3/8-16 x 3 3/4", grade 2
1	CP3	Clip pin .148 x 2-15/16" eye 3/4"

ECC12 Assembly Instructions

Step 1

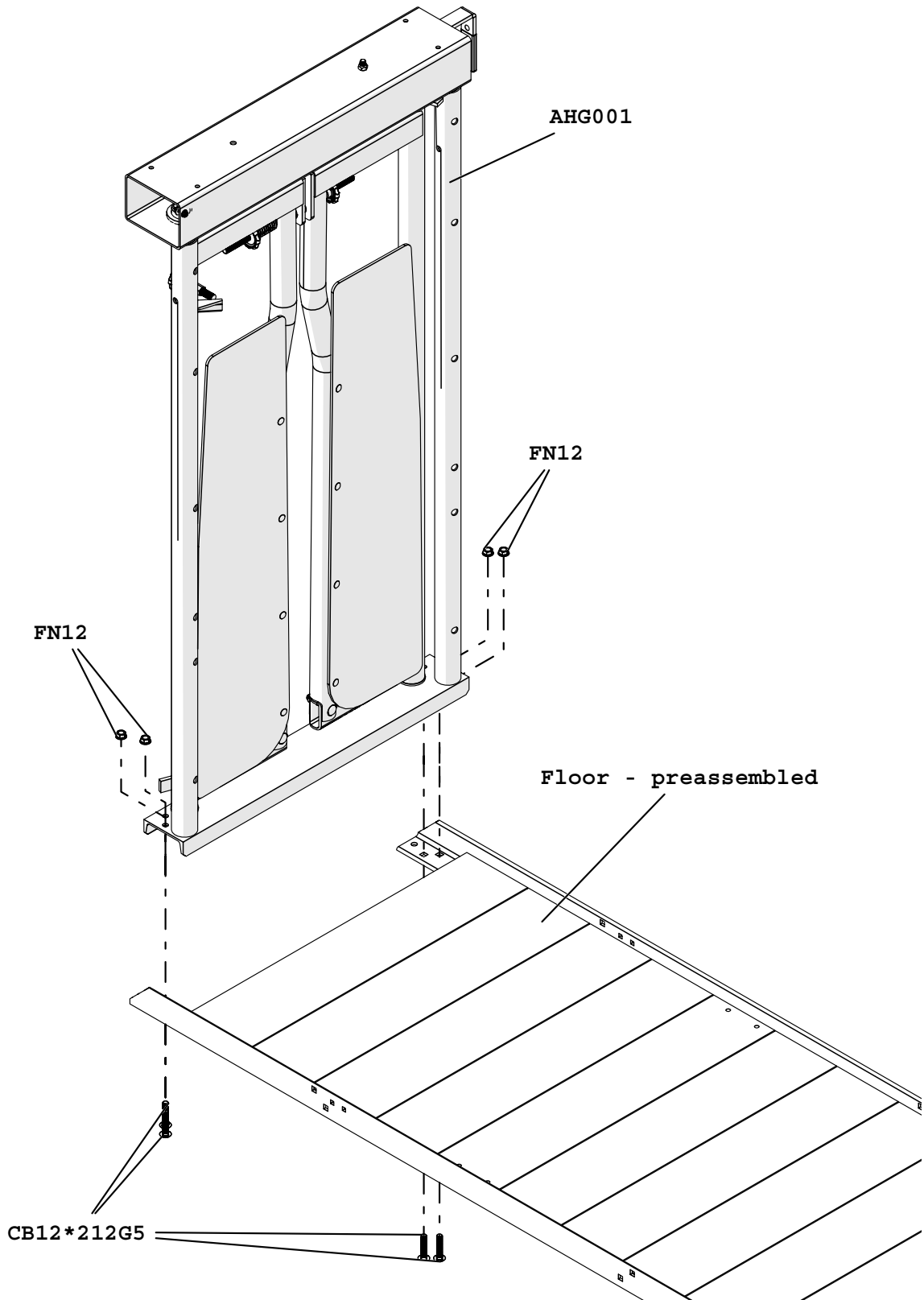

ECC12 Assembly Instructions

Step 2

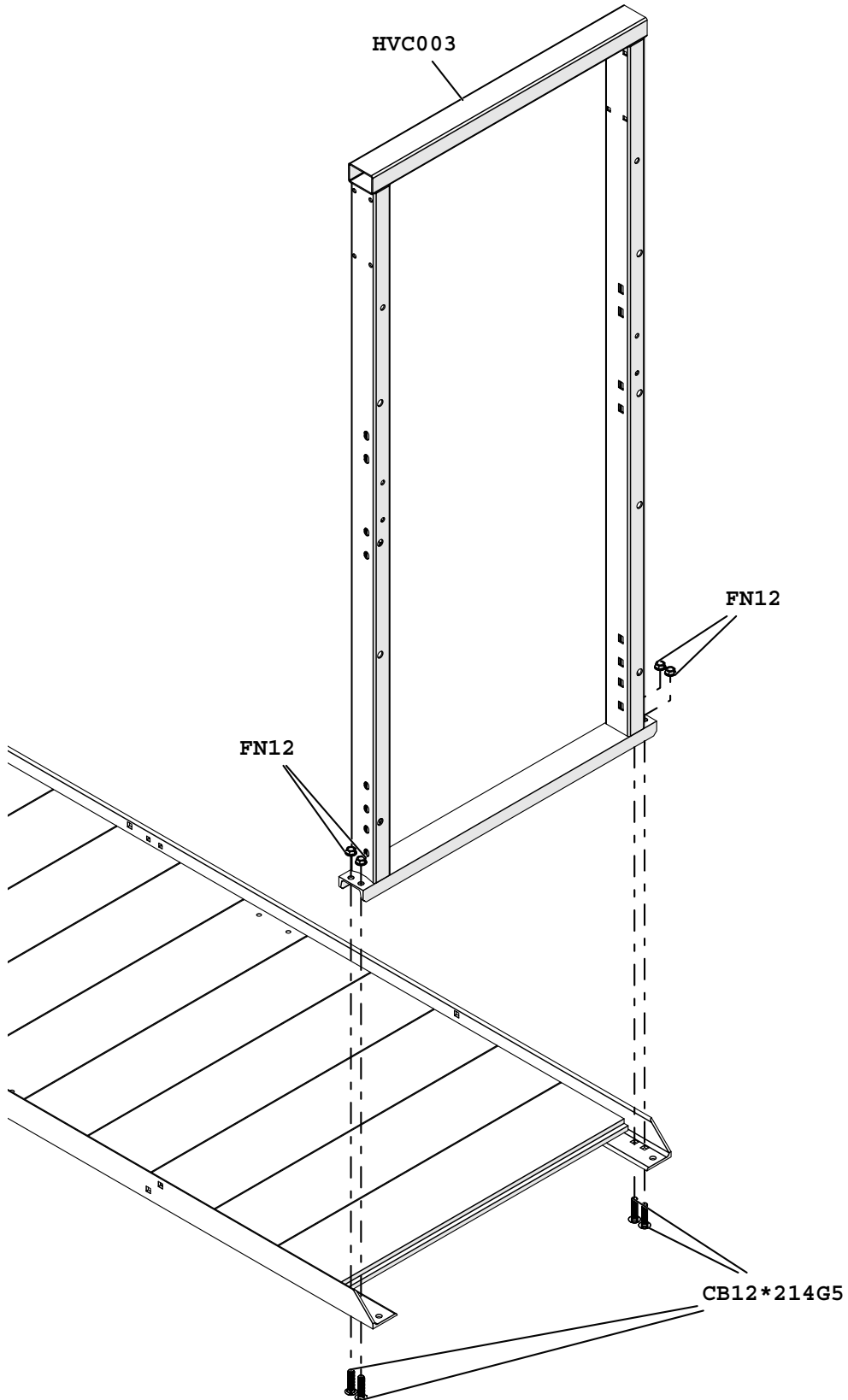

ECC12 Assembly Instructions

Step 3

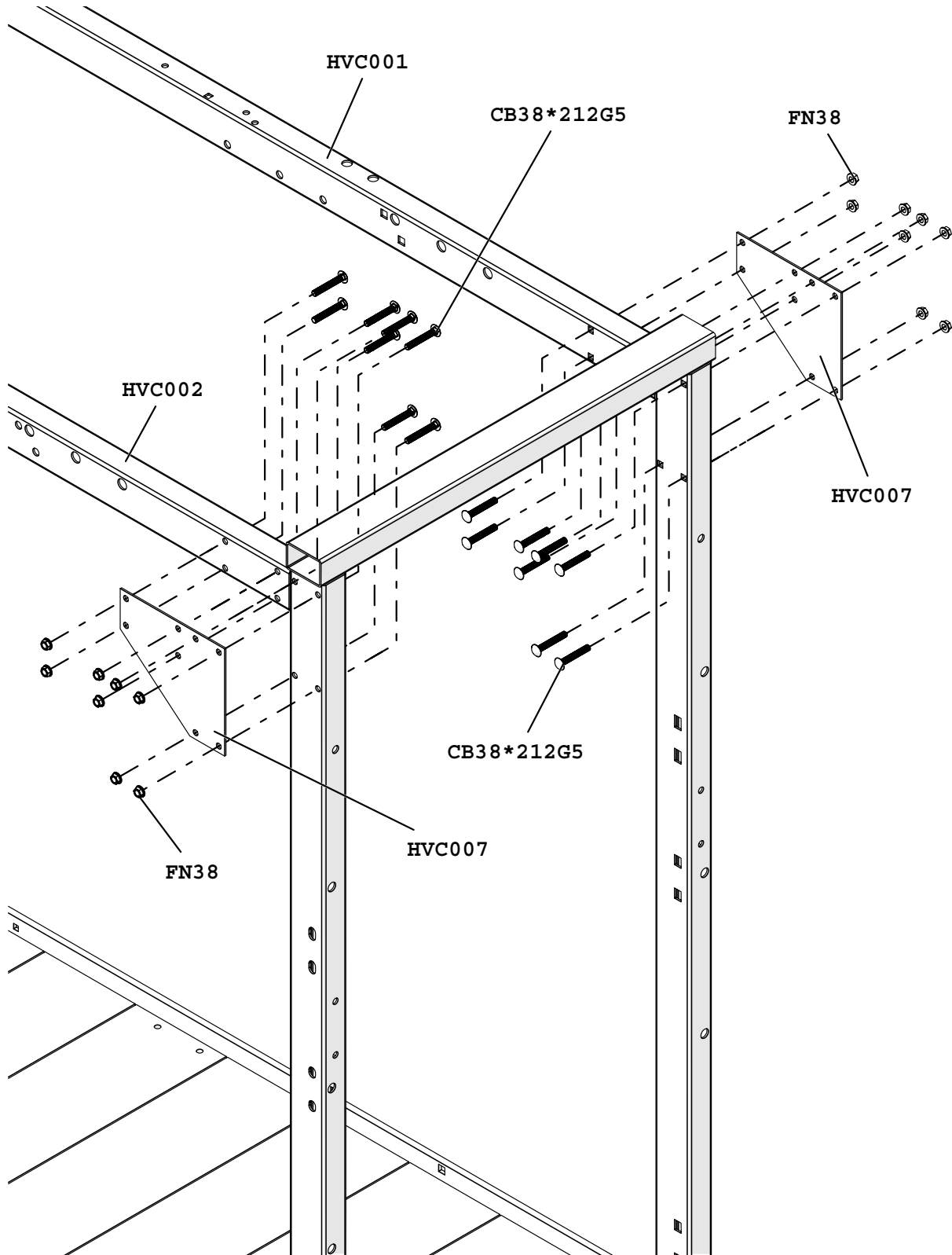

ECC12 Assembly Instructions

Step 4

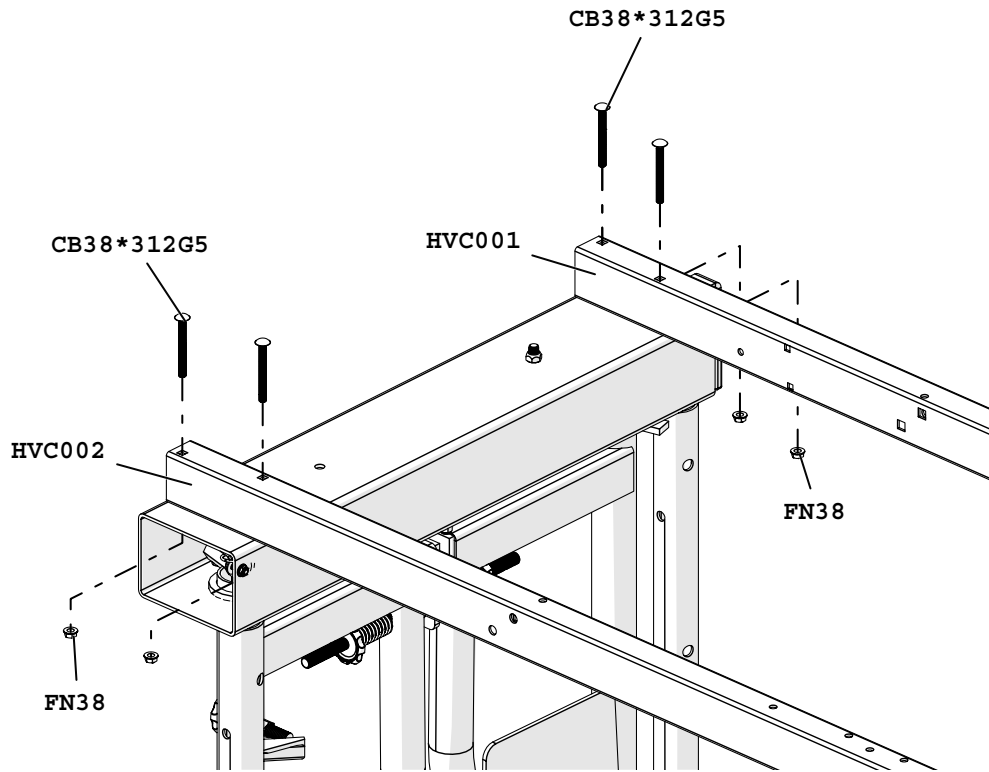

Step 5

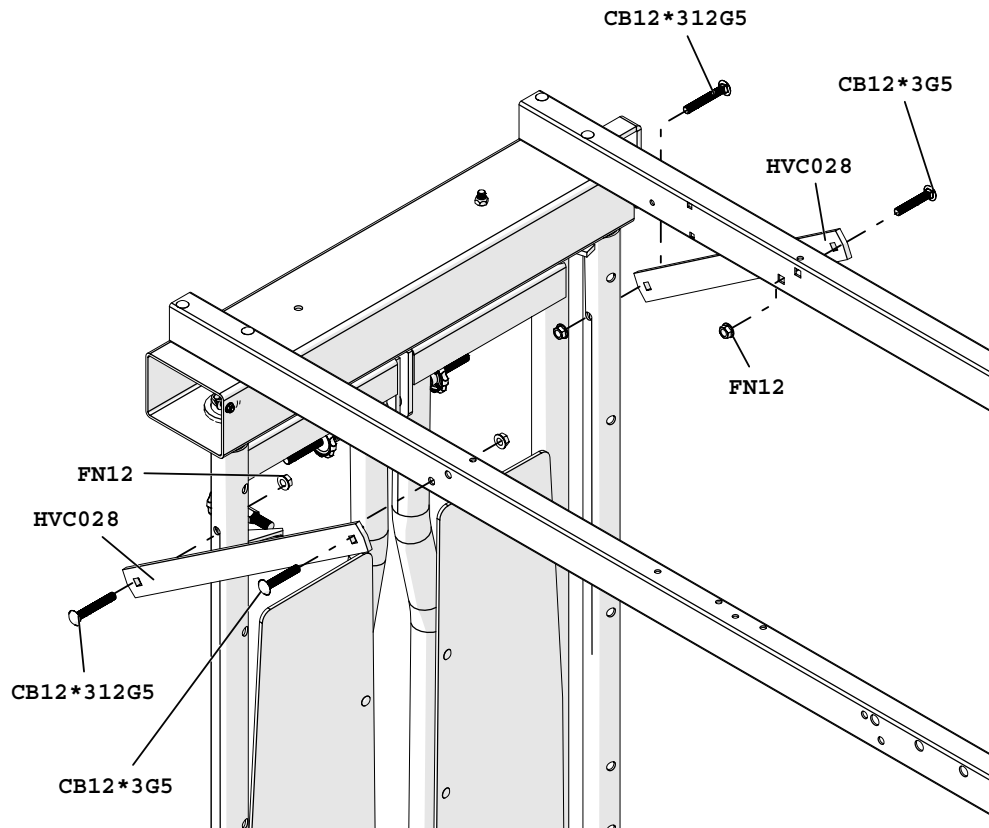

ECC12 Assembly Instructions

Step 6

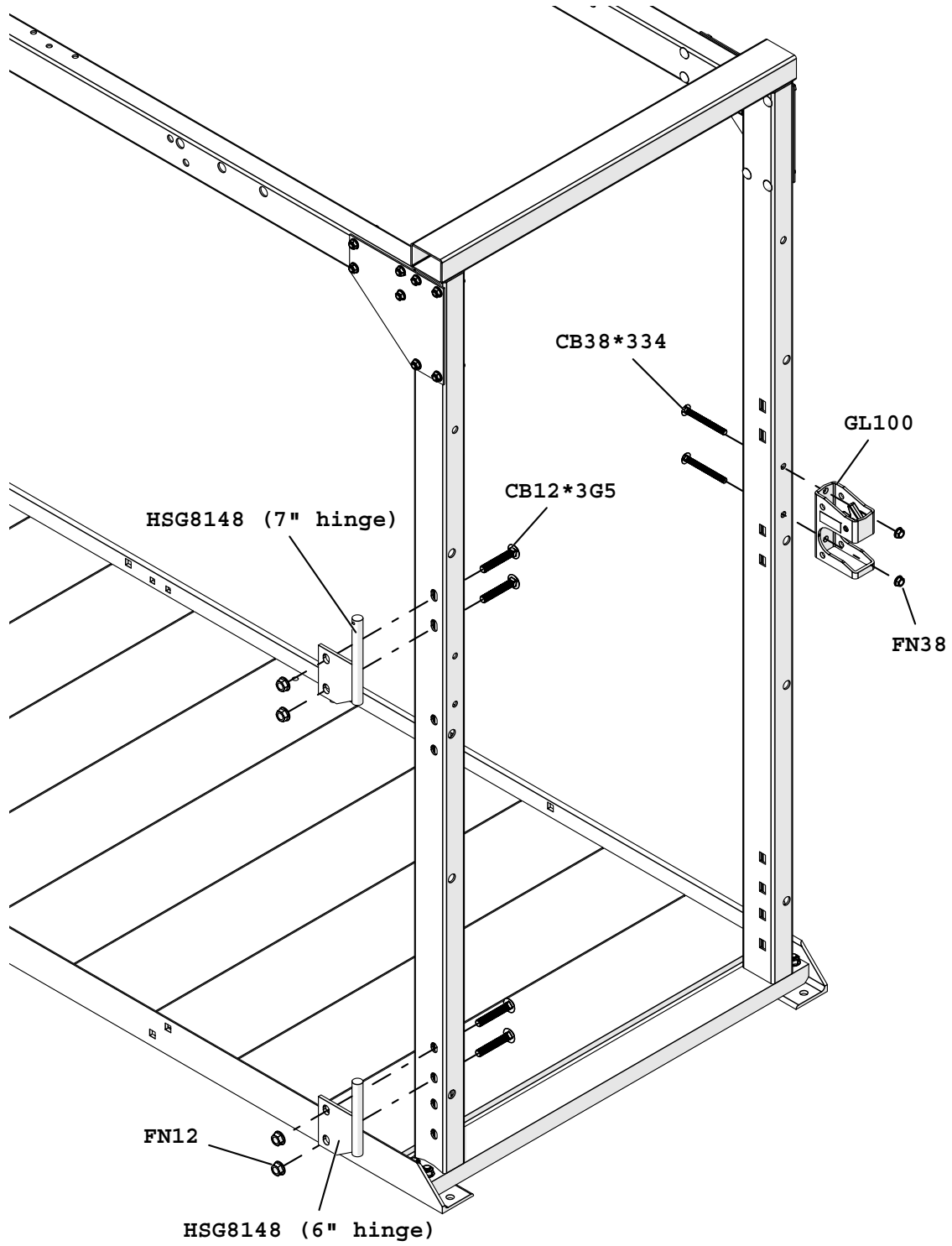

ECC12 Assembly Instructions

Step 7

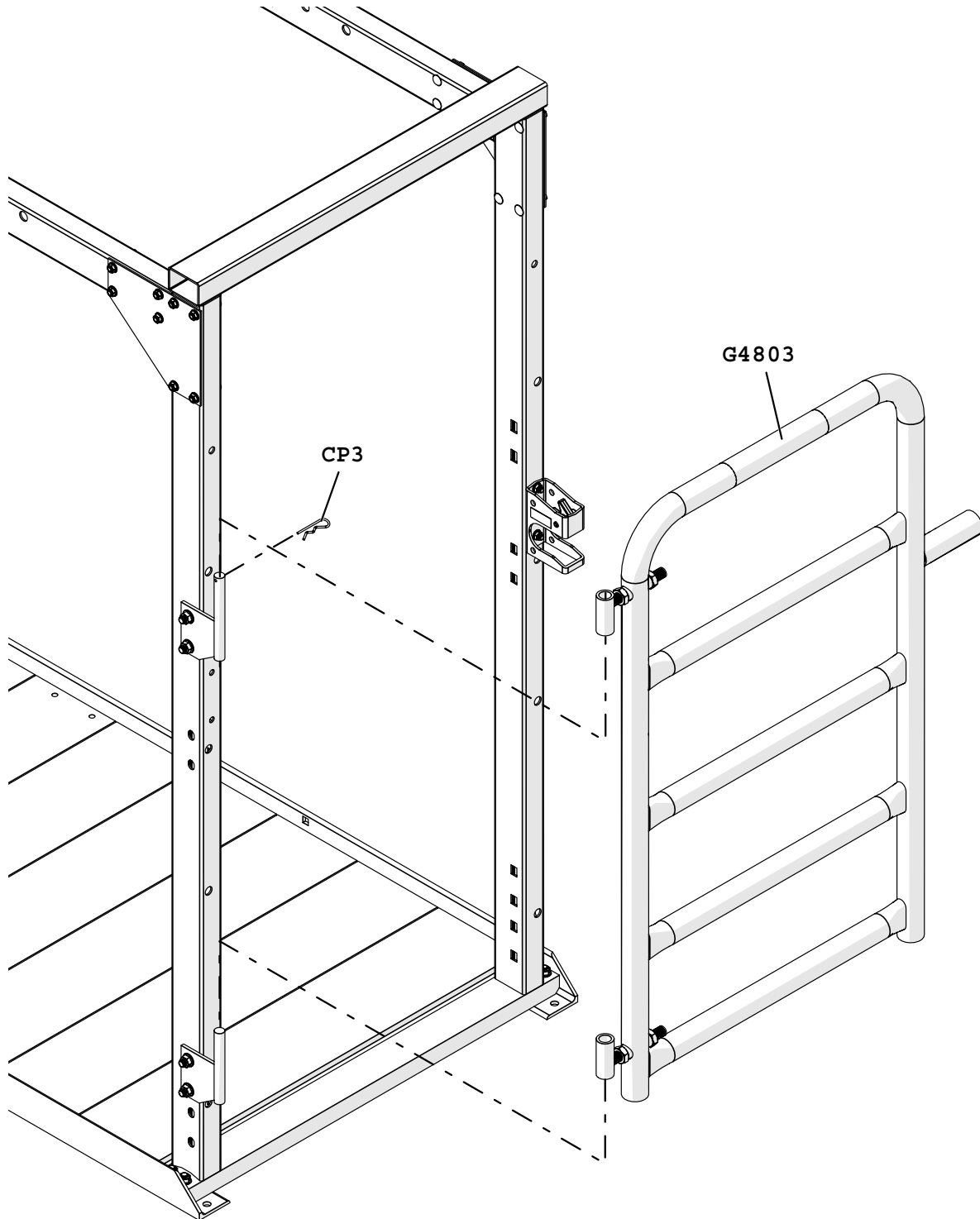

ECC12 Assembly Instructions

Step 8

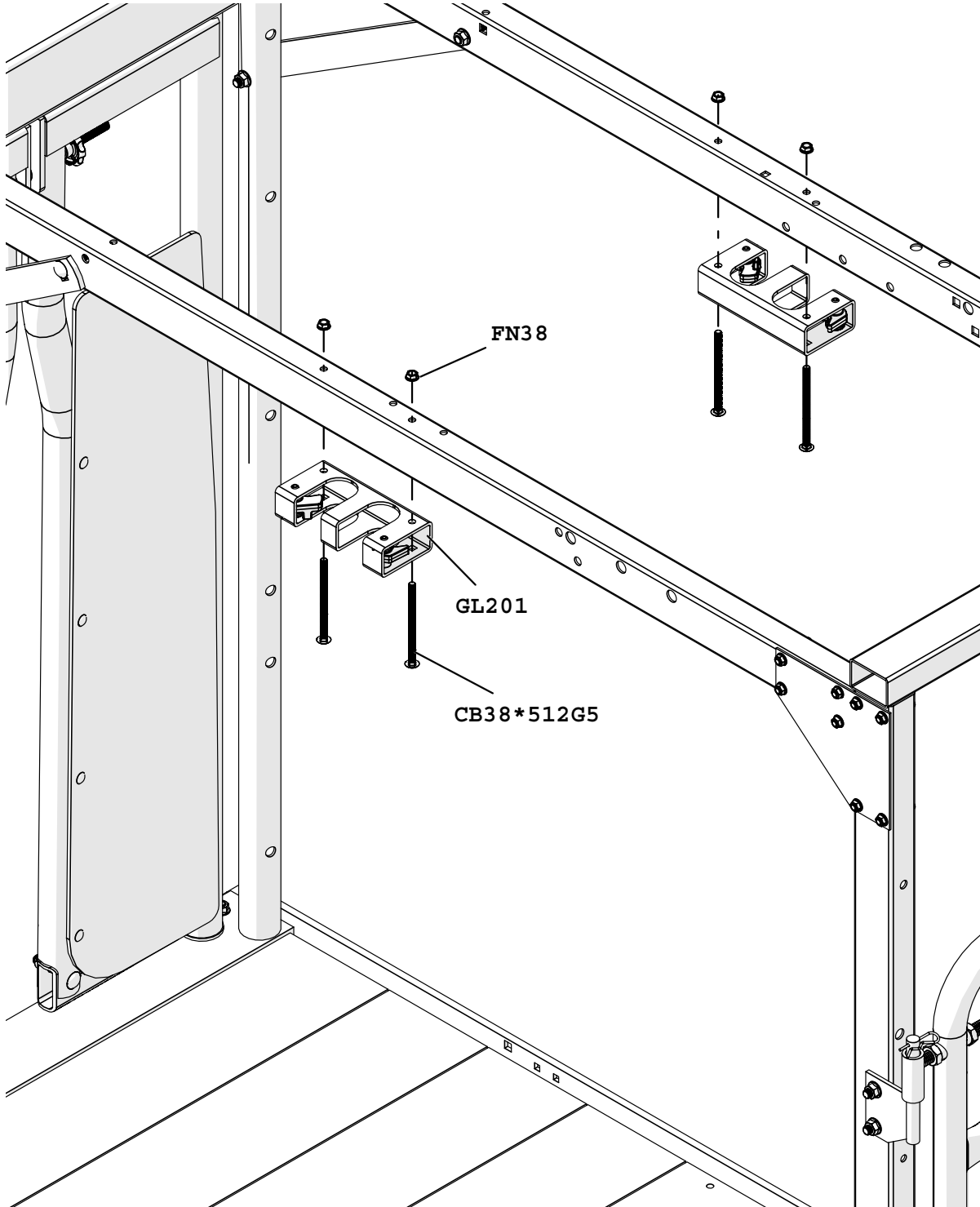

ECC12 Assembly Instructions

Step 9

Note: Repeat on opposite side

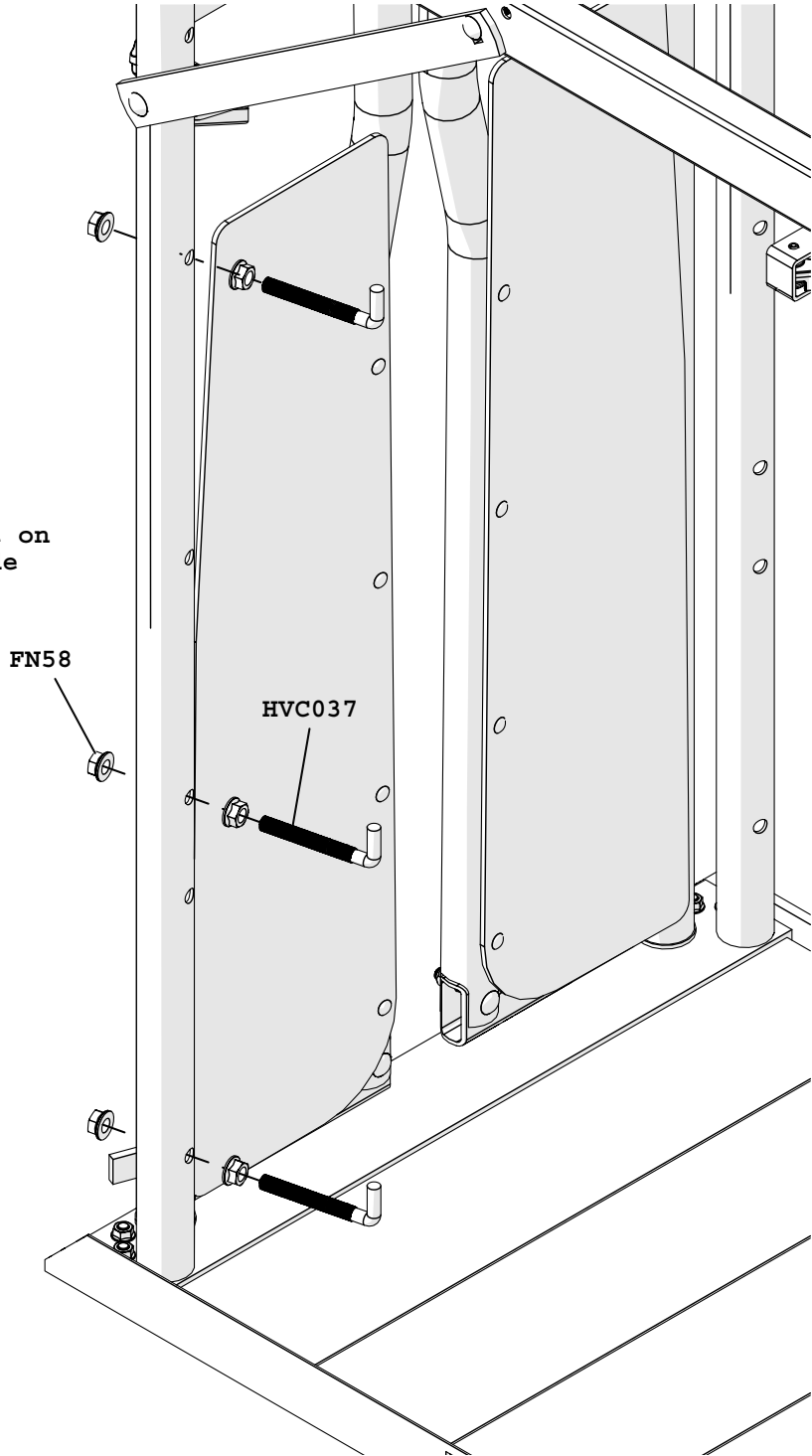

ECC12 Assembly Instructions

Step 10

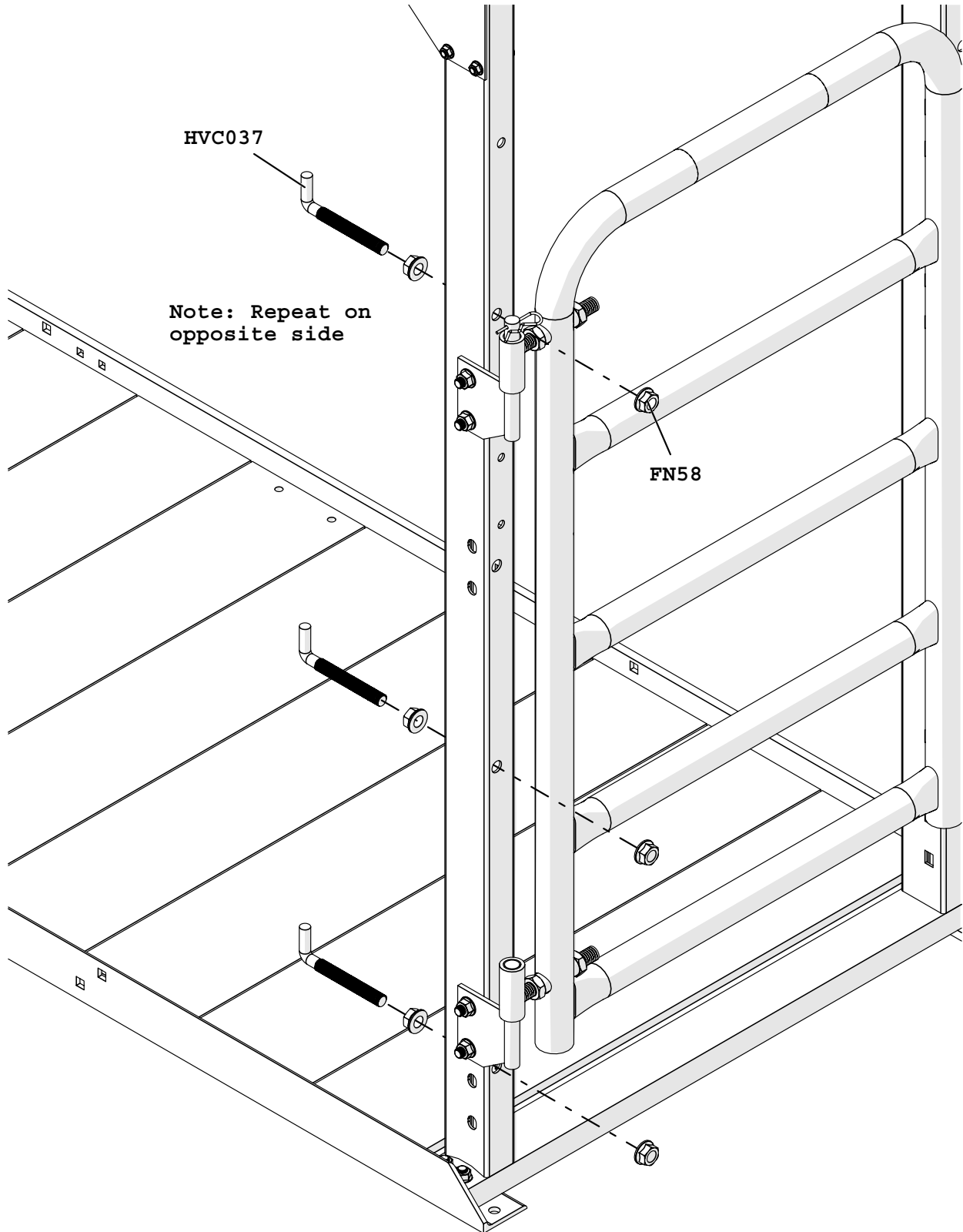

ECC12 Assembly Instructions

Step 11

Note: Adjust the hinge bolts from steps 9-10 so that the gate strikes the gate latch properly

Note: Repeat on opposite side

